

## Insterprep® Bags

Instructions for use

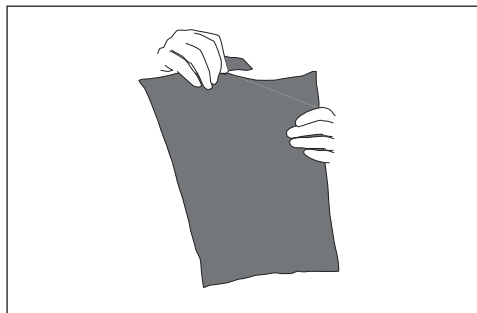

Tear open the irradiated sachet\*

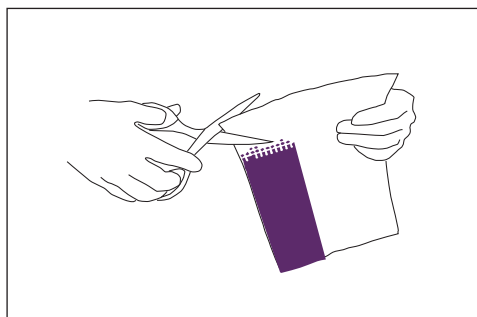

Take out your Insterprep® sterile bag and use scissors to cut open the top along the marked line.



Add sterile de-ionised water as per volume instructions on product (225ml or 3375ml). Add weighed measure of sample material to bag (25g/25ml for 225ml sampling)

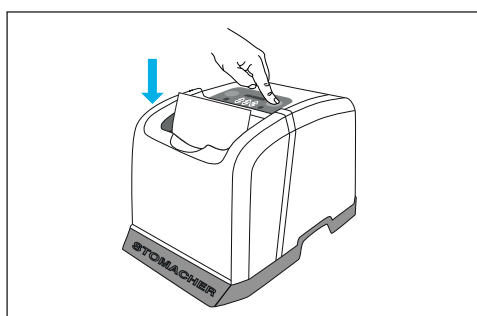

Drop Insterprep® bag into the Stomacher® and begin processing. The paddles will blend your sample at the same time as activating your media. Insterprep® granules will require minimum 30 seconds of blending to dissolve at room temperature

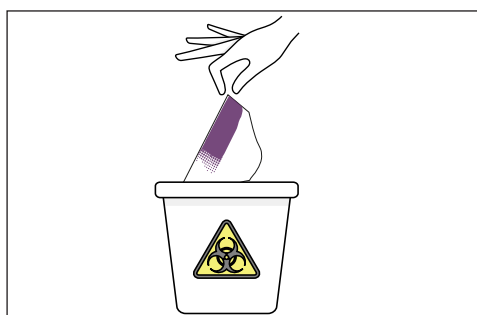

After use sterilise and dispose of bag and biowaste appropriately.

## Insterprep® Sachets

Instructions for use

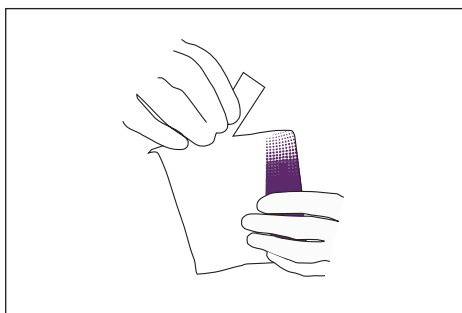

Tear open the media sachet\*

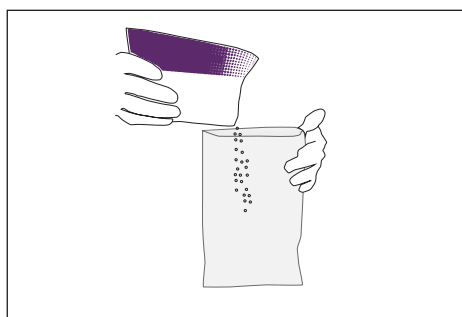

Pour the contents into your Stomacher® bag.

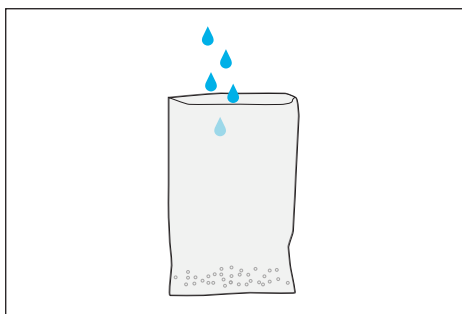

Add sterile de-ionised water as per volume instructions on product (225ml or 3375ml). Add weighed measure of sample material to bag (25g/25ml for 225ml sampling)

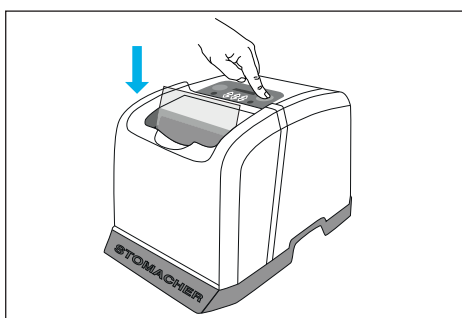

Drop Stomacher® bag into the Stomacher® and begin processing. The paddles will blend your sample at the same time as activating your media. Insterprep® granules will require minimum 30 seconds of blending to dissolve at room temperature.



After use sterilise and dispose of bag and biowaste appropriately.